



Girder grab for horizontal transport model TTT

Capacity 750 - 4500 kg

The girder grab TTT is used for the horizontal transport of steel girders. Due to the split fixed jaw, it can be positioned centrally on the end of the beam.

The grab should only be used in pairs.

The safety lock with positive spring tension holds the grab in position on the end of the girder even without load tension.

The lever is used to engage and disengage the jaw and to keep it open.

The angle from the vertical must not exceed 30°.

Technical data model TTT

Model	EAN-No. 4025092*	Capacity kg	Jaw capacity mm	Weight kg
TTT 0.75	*558501	750	0 - 20	3
TTT 1.5	*558518	1500	0 - 35	6
TTT 3.0	*558525	3000	0 - 40	10
TTT 4.5	*558532	4500	0 - 45	16

Dimensions model TTT

Model	TTT 0.75	TTT 1.5	TTT 3.0	TTT 4.5
A, mm	30	38	50	60
B, mm	70	70	75	90
C, mm	100	155	195	222
D, mm	142	150	195	222
Ø E, mm	50	70	80	90
F, mm	16	19	19	22
G, mm	16	20	25	30
H, mm	225	335	400	450
I, mm	45	45	80	90
J, mm	200	210	214	248
K, mm	106	120	125	147
L, mm	52	66	80	88

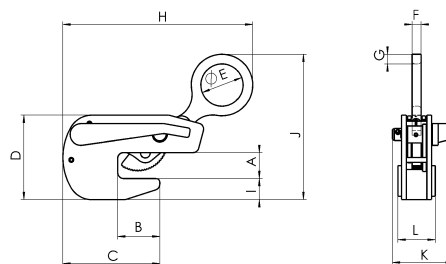

Model TTT